

TruTap

The ideal Bag-in-Box dispensing solution for free-flowing liquids

Worldwide Dispenser's TruTap is ideal for Bag-in-Box packaging and containers with continuous dispensing. It's ergonomic top twist design is suitable for a wide range of free-flowing liquids such as fruit juices, water, coffee, edible oils, syrups, concentrates, condiments and cleaning solvents.

TruTap's spout –which connects the bag and tap together–is suitable for food products meeting FDA and EU regulations.

Features & Benefits

- Easily controllable twist mechanism
- Precision valve shut off
- No post-drip or splash
- Low Oxygen Transmission Rate (OTR)
- Flow rate of 37 mL/sec (1.25 oz./sec)
- Easy-to-use, single handed twist operation



TruTap Top Twist Tap	WD Part Number
Twist Valve	800350
Spout	800360

Item	Component	Material	Color
1	Twist Cap	PP	Black
2	Plunger	HDPE	Natural
3	Body	HDPE	Black
4	Spout	LLDPE	Natural

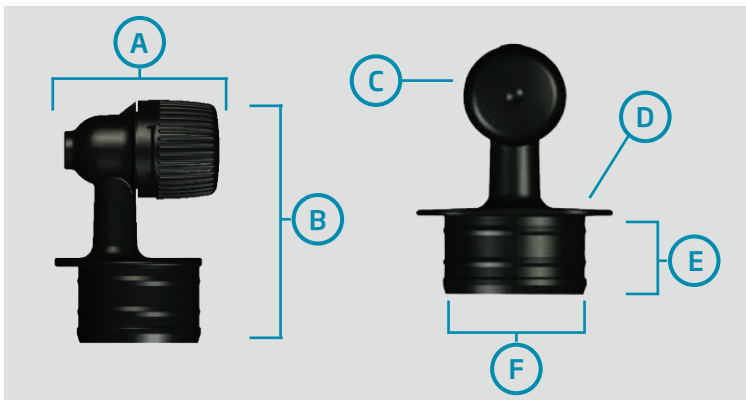

Feature ID	Feature Description	Dimension
A	Valve Height (Total)	1.50" (38.1 mm)
B	Valve Length	2.07" (52.6 mm)
C	Twist Cap OD	0.85" (21.6 mm)
D	Handling ring Diameter	Ø1.60" (Ø40.6 mm)
E	Spout Seal Bead Length	Ø.65" (Ø16.5 mm)
F	Spout Seal Bead Diameter	Ø1.17" (Ø29.7 mm)

*Dimensions verified within 24hrs of molding

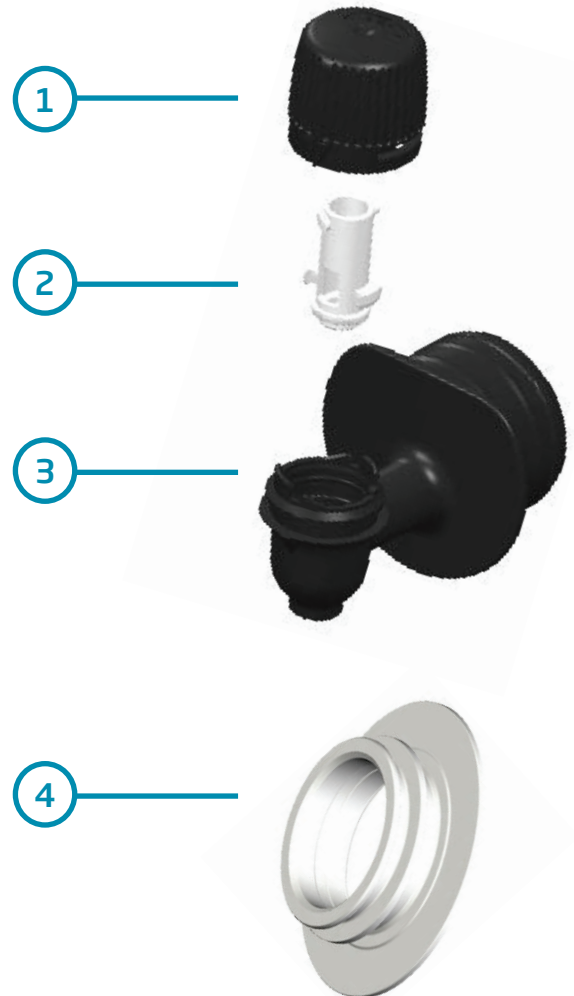

Performance Description	Manufacturing Criteria	Notes
Leak Test	< 0.7 ccm @ 3.5 psi	Pressure decay test
Oxygen Transmission Rate	< 0.04 cc/pkg/day	@75% R.H., 23°C, 20.9% O2
Flow Rate	1.25 ounces/ second	Tap water at 6" of head-pressure
Minimum Open Torque	2 lb-in	@ 60° rotation/sec
Maximum Open Torque	6 lb-in	@ 60° rotation/sec